

# RGB LED ROCK LIGHT REMOTE CONTROL KIT



## USER MANUAL



MADE IN CHINA

## WARNING

1. Make sure all lights are connected to the control box when first powering up. Anomaly might occur when at least one output of the control box is left disconnected.
2. Similarly, do not unplug when the control box is connected to power. Cut main power before doing any maintenance.
3. The lights must be used only for the prescribed purpose. Any uses outside those mentioned in the manual will be considered misuse. The manufacturer shall not be liable for any damage or injuries resulting from misuse. To use the lighting kit properly, please closely observe the instructions found in the manual.
4. Keep children away from electrical equipment. Make sure children are under supervision when operating the light kit.
5. Do not use any power supply that outputs any voltage outside of the lights' nominal voltage range. Over-voltage can cause irreversible circuitry damage and even fires.
6. Do not put the lights in the temperature outside of the operational range.
7. Do not clean your lights with harsh detergents. The lights are water-proof but not guaranteed to be protected against other chemicals.

# PARTS LIST

Index	Item name	Item qty.	Item details
1	Rock light pods	X	X = 4, 6 or 8 based on configurations Plug: 4-pin male
2	Control box assembly	1	Attached: 1 control box, 1 main power switch, 1 distribution harness, X 4-pin female plugs, 2 battery terminal wires, 1 fuse at positive terminal wire
3	Mounting packs	X	Each pack contains: 1 mounting pad, Screws/bolts based on configurations

# CABLE SCHEMATICS

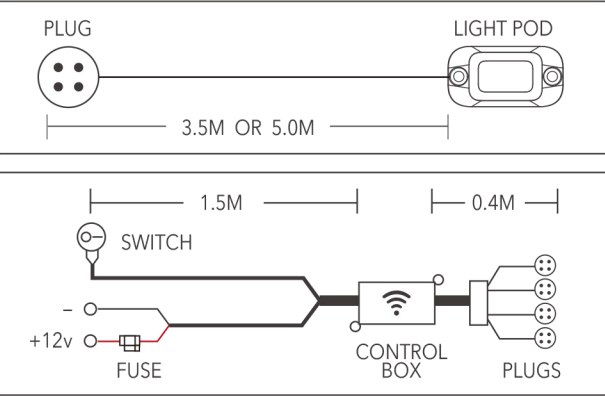

# INSTALLATION - GENERAL

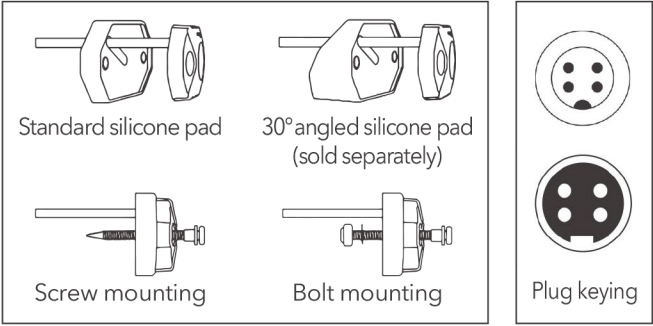

1. Position the light pods and the control box on the desired mount points on your vehicle's body. (See "Installation - Recommended Mount Points")
2. Drill screws to secure the light bars and their mounting pads in place. (see graphics above)
3. Mount the control box on the chassis or in the engine bay with adhesives. Similarly mount the main switch in the vehicle's interior/cab.
4. Connect the light pods' wires with the control box according to the plugs' correct orientations. (plug keying seen above)
5. Connect the red and black power leads from the control box to the vehicle's auxiliary battery. Add a fuse to the interconnect if required. Disconnect the red power lead when fine-tuning the installation.
6. Use zip ties to tidy up the control box and the dangling wires.

## INSTALLATION - RECOMMENDED MOUNT POINTS



CONTROL BOX



SWITCH



LIGHT POD

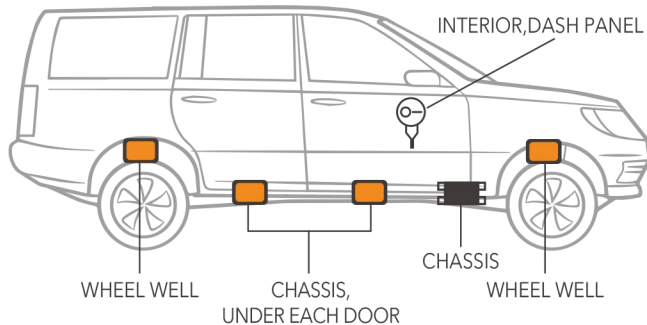

## INSTALLATION - EXAMPLE



LIGHT POD ON WHEEL WELL



SWITCH ON DASH PANEL

04

## USE GUIDE - BLUETOOTH APP

HappyLighting  
qh-tek



Available for:  
Android (4.3 or later), iOS (9.0 or later)

Scan QR code for Android APK download or  
Google Play store page



05

## USE GUIDE - FIRST USE

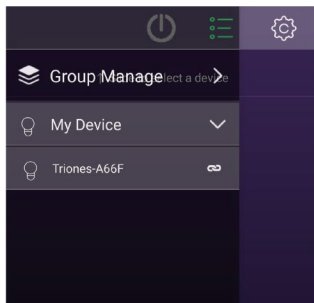

Device manager menu

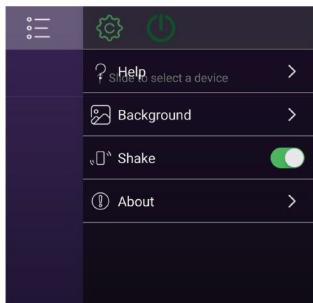

App settings menu

1. When wiring is secure, turn on the power source for your light kit.
2. Turn on Bluetooth via your phone's settings.
3. Open the HappyLighting app and allow location tracking permissions (this only enables Bluetooth).
4. Tap the ☰ icon for to the device manager menu.
5. Find the device ID of your light kit, and tap the ID to pair your phone with the light kit.
6. Tap the ⚙ icon for the app settings menu. Consult the help pages to explore the app.

## USE GUIDE - "ADJUST" PAGE

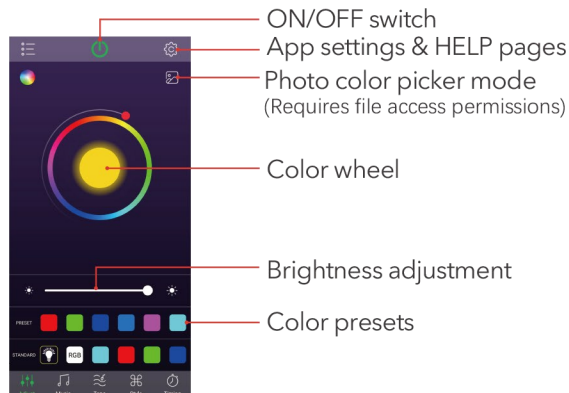

To explore more functions,  
please read the HELP pages in the app.

